

Electrical Needs: Each booth will receive one 110 volt/500 watt outlet at no extra cost to exhibitor. Additional electrical needs will be subject to fees. Please indicate additional needs:

Voltage Wattage Amperage _____
 Special Electrical Requests _____

RV/Stock Truck/Dead Storage Requirements: If RV, Stock truck or dead storage is needed, please indicate type and amount of space needed for each. We will be charging \$50 for Stock Truck hookup. Example: Water, Sewage, Electricity, Elec only or No Utilities, 27' needed

RV _____ Stock Truck _____ Dead Storage _____

Prices for exhibit spaces: Pipe & drape provided for inside spaces only

Outdoor Space: 10'x10' - \$275; 10'x 20' - \$375; 10'x30' - \$500

Outdoor space to be assigned by Manager.

Amount of space needed _____

Indoor Space: 10'x10' in-line-\$300; 10'x10' corner-\$325; 10'x 15' wall-\$350

Amount of space needed (have only 3 10'x15') _____

- ALL INDOOR SPACE IS LOCATED IN PAVILION BUILDING – SEE MAP
- Additional 2nd adjoining 10' x 10' space will be \$150.00 more.
- An additional \$75 will be charged to vendors who are selling items or taking orders for merchandise. No additional fee for information only.

Booth Space Choice - 1st Choice # _____ 2nd Choice # _____ 3rd Choice # _____

No guarantee that your choice of space will be available.

PAVILION BUILDING DIAGRAM (not to scale – sample only)

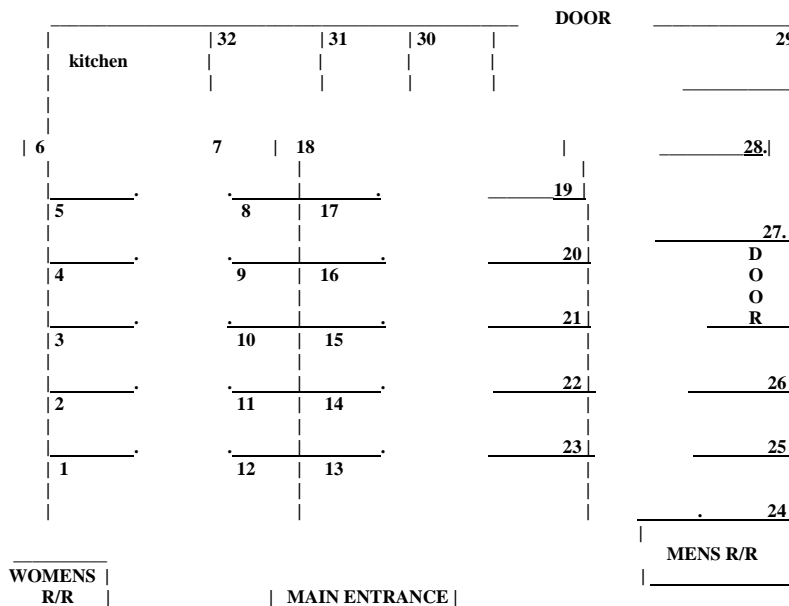

#26, 27 & 29 are 10' x 15' and the rest are 10' x 10' spaces
 #19, 20, 21, 22, 23 will have only 3' dividers - no 8' back

Application must be accompanied by complete list of all items sold and a picture of completed booth.

Deadline for applications is March 15, 2010.

We will continue to take applications for a wait list until May 1, 2010.